

34535 IH 10 West
 Boerne, TX 78006
 (830) 249-2920
 hillcountryclassics.com

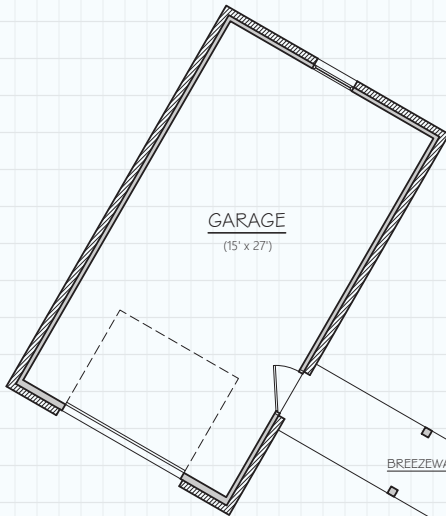

THE CASTROVILLE #1533

LIVING (A/C):	1,533 SQ. FT.
PORCHES:	402 SQ. FT.
GARAGE:	448 SQ. FT.
MAS. LUG:	91 SQ. FT.
SLAB:	2,474 SQ. FT.

